

Intelligent Drivesystems, Worldwide Services



# Electric Motors & Brakemotors

40 - 75 Hp Premium Efficiency Motors

4 pole • 50 & 60Hz

225 Frame Motors and Brakemotors  
Order Preassembled or Customized to Your Requirements

**PRODUCT OVERVIEW**

**M7002**

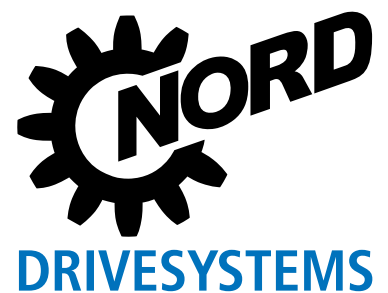

## Spanning the globe To serve you

Since 1965, NORD has become well established in the power transmission industry and grown to global proportions on the strength of product performance, superior customer service, and intelligent drive solutions. NORD is constantly improving and expanding its products to meet a never-ending variety of industrial challenges.

NORD designs and manufactures drive systems engineered for adaptability. NORD's innovative drive solutions are specified and utilized for a range of applications in nearly every industry throughout the world.

NORD Drivesystems' product portfolio is extensive and continuously evolving in order to meet the needs of today's fast-changing markets. NORD's range of drive equipment includes: helical in-line, helical shaft-mount, helical-bevel, helical-worm and worm gear units with torques from 90 lb-in to 2,200,000 lb-in, readily available AC motors and from 1/6 HP to 250 HP, variable frequency drives up to 250 HP, and mechanical variable speed drives.

But NORD does far more than manufacture the world's finest drive components. We provide our customers with optimum drive configurations for their specific purposes, providing each and every one with truly complete and efficient systems at a price/quality ratio unmatched in today's competitive markets.

NORD makes its wide product range easily available through a global network that includes representation in over 60 countries. By providing all of our customers with prompt delivery, and expert support services, we are firmly committed to exceeding customer expectations and being responsive to the ideas and specifications of every customer, anywhere in the world.

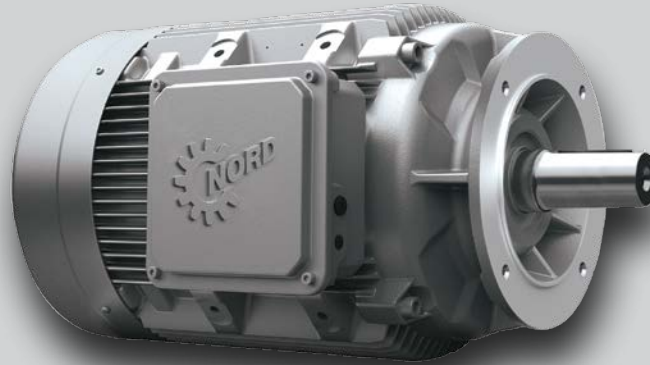

### **NORD 40-75 Hp Motors & Brakemotors**

Due to demand for higher powered motors that meet current global efficiency requirements, NORD has added 40-75 Hp (30-55 kw) motors to our existing line of induction motors & brakemotors. This catalog supplement contains information on the NORD, 40-75 Hp premium efficient, inverter-duty motors.

Like all NORD motors, these are a durable, low maintenance design developed to meet the demands of a wide array of applications. Motors, primary assembly components and accessories are stocked at our factories to allow adaptability and provide our customers with the advantage of short and reliable delivery times. Accessories and options are easily added and available on demand, including: brakes, encoders, constant speed ventilator fans, motor overload protection devices, space heaters and more.

The NEW 40-75 HP NORD motors are fully compatible with the NORD modular system to maintain simple, cost-effective designs. All four frame sizes including, 225RP, 225SP, 225MP, and 250 WP are available as integral gearmotor combinations. Multiple sizes are available with a foot-kit or input flange.

For additional information about other NORD products including gearmotors, gear units, and NORD Variable Frequency Drives please visit [www.nord.com](http://www.nord.com) or contact NORD directly.

#### **Features and Benefits**

- Threaded cable entry holes
- Lip seals on both shaft ends
- Sealed and gasketed terminal boxes.
- Continuous Duty (S1) / Premium Efficient (IE3).
- Common 50 Hz and 60 Hz voltages.
- Inverter/vector duty wiring and insulation.
- Rated for voltage spikes per NEMA MG1-2011, section 31.4.4.2
- Moisture resistant varnished dipped windings.





**DRIVESYSTEMS**

# Table Of Contents

|   |    |
|---|----|
| Selection & Nomenclature .....                  | 4  |
| Mounting Position & Terminal Box Position ..... | 5  |
| Available Options .....                         | 6  |
| Available Brake Torques & Options .....         | 3  |
| Performance Data.....                           | 8  |
| IEC B3 Motor Dimensions .....                   | 9  |
| IEC B3 Brakemotor Dimensions .....              | 12 |
| IEC B5 Motor Dimensions .....                   | 15 |
| IEC B5 Brakemotor Dimensions .....              | 18 |
| Integral B5 Motor Dimensions .....              | 21 |
| Integral B5 Brakemotor Dimensions .....         | 24 |

# Selection & Nomenclature



Information

**SK**
Frame ①
Size ②
Poles ④
Mounting ③
Motor Options ⑤
Brake Size ⑥
Brake Options ⑦

| Size & Frame Combinations ① ② |      |    | Available Mounting Combinations ③ |               |          |     | Brake Size ⑥   |       | Poles ④    |            |      |
|-------------------------------|------|----|-----------------------------------|---------------|----------|-----|--|-------|------------|------------|------|
| Frame                         | Size |    | IEC B3 Foot                       | IEC B5 Flange | Integral |     | <input type="radio"/> BRE 400<br><input type="radio"/> BRE 800 | Poles | 60Hz [rpm] | 50Hz [rpm] |      |
| 225                           | RP   |    | ---                               | ---           | 300      | 350 |  |       | 4          | 1800       | 1500 |
| 225                           | SP   | MP | B3-225                            | A450          | 350      | --- |  |       |            |            |      |
| 250                           | WP   |    | ---                               | ---           | 350      | 450 |  |       |            |            |      |

| Motor Options ⑤  |  | Brake Options ⑦   |  |
|--|--|---|--|
| <b>Electrical Motor Options</b><br><input type="checkbox"/> <b>TW</b> - Thermostat<br><input type="checkbox"/> <b>TF</b> - Thermistor<br><input type="checkbox"/> <b>SH</b> - Space Heater (select voltage)<br><input type="radio"/> 110 Volt <input type="radio"/> 230 Volt <input type="radio"/> 460 Volt<br><input type="checkbox"/> <b>ISO H</b> - Class H insulation<br><b>AC Drive Related Motor Options</b><br><input type="checkbox"/> <b>F</b> - Blower Fan (200-575V 1 & 3 Phase)<br><input type="checkbox"/> <b>FC</b> - Blower Cooling Fan (115V, 1 Phase)<br><input type="checkbox"/> <b>IG__</b> - Incremental Encoder<br><input type="checkbox"/> <b>IG__P</b> - Incremental Encoder with Plug<br><b>IG &amp; IG__P Options:</b><br><b>Logic:</b> <input type="radio"/> TTL <input type="radio"/> HTL <input type="radio"/> Push-pull<br><b>Supply:</b> <input type="radio"/> 4-6V <input type="radio"/> 10-30V <input type="radio"/> 5-30V<br><b>PPR:</b> <input type="radio"/> 1024 <input type="radio"/> 2048 <input type="radio"/> 4096<br><input type="checkbox"/> <b>AG</b> - Absolute Encoder<br><b>AG Options:</b> Turns <input type="text"/> Step <input type="text"/><br><b>AG Bus System:</b> <input type="text"/> |  | <b>Environmental Motor Options</b><br><input type="checkbox"/> <b>RD</b> - Canopy Drip Cover<br><input type="checkbox"/> <b>RDD</b> - Double Fan Cover<br><input type="checkbox"/> <b>KB</b> - Condensation Drain Holes (plugged)<br><input type="checkbox"/> <b>KBO</b> - Condensation Drain Holes (open)<br><input type="checkbox"/> <b>KKV</b> - Terminal Box Sealed with Resin<br><input type="checkbox"/> <b>AICM</b> - Additional Insulation<br><input type="checkbox"/> <b>EP</b> - Epoxy Dipped Windings<br><b>Additional Motor Options</b><br><input type="checkbox"/> <b>OL</b> - Totally Enclosed Non-Ventilated (TENV)<br><input type="checkbox"/> <b>OL/H</b> - (TENV) Without Fan Cover<br><input type="checkbox"/> <b>WE</b> - Second Shaft Extension (Fan Side)<br><input type="checkbox"/> <b>RLS</b> - Motor Backstop (rotation viewing fan)<br><input type="radio"/> Clockwise <input type="radio"/> Counter-Clockwise<br><input type="checkbox"/> <b>EKK</b> - Small Terminal Box<br><input type="checkbox"/> <b>MS</b> - Quick Power Plug Connector<br><input type="checkbox"/> <b>RS</b> - Round Motor Power Plug Connector |  |
|  |  | <b>HL</b> - Hand Release Lever<br><b>FHL</b> - Locking Hand Release Lever<br><b>HLH</b> - Hand Release Lever with Hole<br><b>RG</b> - Corrosion Protected Brake<br><b>SR</b> - Dust & Corrosion Protected Brake<br><input type="checkbox"/> <b>ADJ</b> _____ Nm -<br>Brake Torque Adjustment<br><input type="checkbox"/> <b>BIP66</b> - IP66 Brake Enclosure<br><input type="checkbox"/> <b>MIK</b> - Micro-switch<br><input type="checkbox"/> <b>BSH</b> - Brake Heating<br><input type="checkbox"/> <b>NRB1</b> - Quiet Brake Release<br><input type="checkbox"/> <b>NRB2</b> - Quiet Brakemotor Operation<br><input type="checkbox"/> <b>DBR</b> - Double Brake<br><input type="checkbox"/> <b>G...P</b> - High Performance Rectifier<br>(See Rectifier Selection Below)<br><input type="checkbox"/> <b>G...V</b> - Sealed Rectifier<br>(See Rectifier Selection Below)<br><input type="checkbox"/> <b>IR</b> - Current Sensing Relay  |  |
|  |  | <b>Duty</b><br><input type="radio"/> <b>Continuous S1</b><br><input type="radio"/> <b>Time Rated S2</b> [min]<br><input type="radio"/> <b>Intermittant S3</b> [%]   |  |
|  |  | <b>Enclosure</b><br><input type="radio"/> <b>IP55</b><br><input type="radio"/> <b>IP65</b><br><input type="radio"/> <b>IP66</b>   |  |
|  |  | <b>Country of Use</b><br><input type="text"/>   |  |
|  |  | <b>Power</b><br><input type="text"/> [hp/kW]  |  |
|  |  | <b>Standards</b><br><input type="radio"/> <b>North American [CUS]</b><br><input type="radio"/> <b>International [IEC]</b><br><input type="radio"/> <b>Other:</b> _____  |  |
|  |  | <b>Hazardous Location</b><br><input type="radio"/> <b>None</b><br><input type="radio"/> <b>Class 1 Div 2 - Gas</b><br><input type="radio"/> <b>Class 2 Div 2 - Dust</b><br><input type="radio"/> <b>Global - ATEX</b>   |  |

| Voltage & Frequency  |
|--|
| <b>Single Speed Motors</b><br><input type="radio"/> 460V-60Hz<br><input type="radio"/> 575V-60Hz<br><input type="radio"/> 400V-50Hz<br><input type="radio"/> Other |

| Terminal Box Position  |
|--|
| <input type="radio"/> TB1<br><input type="radio"/> TB2<br><input type="radio"/> TB3<br><input type="radio"/> TB4 |

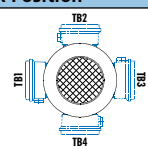

| Conduit Entry Location   |
|--|
| <input type="radio"/> CE I *<br><input type="radio"/> CE II<br><input type="radio"/> CE III *<br><input type="radio"/> CE IV |

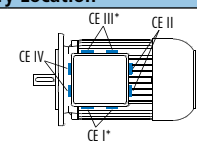

\*Brakemotor

| Hand Release Position  |
|--|
| <input type="radio"/> HL1<br><input type="radio"/> HL2<br><input type="radio"/> HL3<br><input type="radio"/> HL4 |

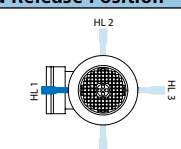

## Nomenclature

| Frame Size 225 or 250             |   |   |     |
|-----------------------------------|---|---|-----|
| Power Code R, S, M, W             |   |   |     |
| Efficiency: P = Premium Efficient |   |   |     |
| Number of Poles                   |   |   |     |
| 225                               | R | P | / 4 |

| Type     | [HP] | [kW] | Efficiency Class        |
|----------|------|------|-------------------------|
| 225 RP/4 | 40   | 30   | Premium Efficient (IE3) |
| 225 SP/4 | 50   | 37   | Premium Efficient (IE3) |
| 225 MP/4 | 60   | 45   | Premium Efficient (IE3) |
| 250 WP/4 | 75   | 55   | Premium Efficient (IE3) |



## Mounting Positions

The motor mounting position helps to determine the use of specific options as well as help specify the terminal box location as well as the conduit entry location. If considering any mounting positions that are not shown as catalog-standard options, it is critical that the customer consult with NORD prior to ordering. When mounting motors, secure the motor tightly to the mounting base of your equipment or onto to a flat and rigid surface.

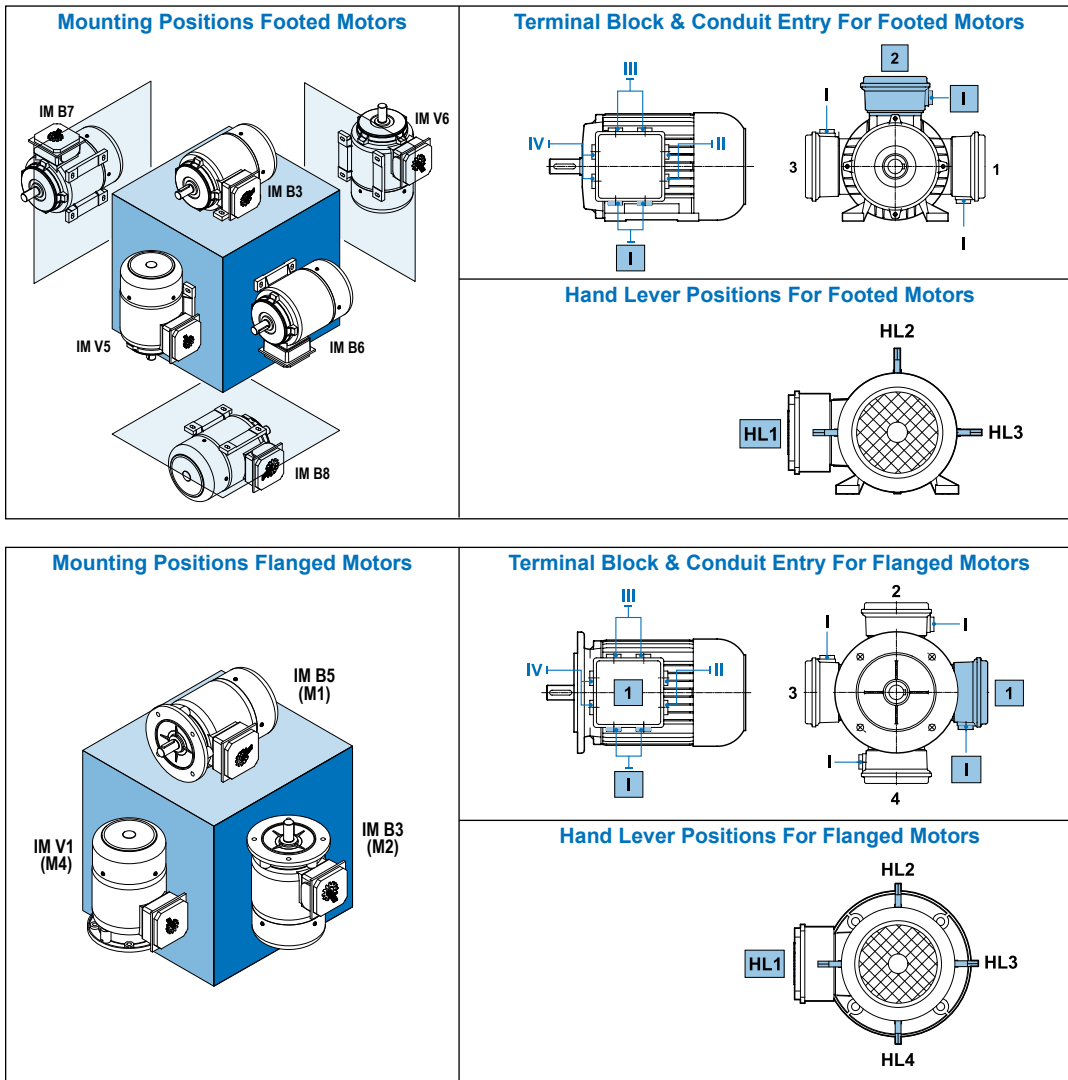

# Available Options

## 40 - 75 hp Motors



### Motor Options & Construction

NORD motors are stocked in one of two ways. The first method is to stock a complete motor that is ready to be assembled to a gear reducer or shipped as a stand alone motor. The second method, the motor is assembled from component parts. The **M** next to a motor option designates that the option can be added to a complete motor by simple modification. The **B** next to a motor option indicates that the motor will need to be built from component parts in order to incorporate the motor option.

#### Motor Options

| Abbreviation | Description                                       | M | B | M7000 Page |
|--------------|---|---|---|------------|
| AG           | Absolute Encoder                                  |   | ✓ | 103        |
| AICM         | Additional Insulation                             |   | ✓ | 93         |
| BRE          | Brake   |   |   | 107        |
| EP           | Epoxy Dipped Windings                             |   | ✓ | 93         |
| F            | Blower Cooling Fan                                | ✓ |   | 96         |
| IG...P       | Incremental Encoder                               |   | ✓ | 102        |
| ISO H        | Class H Insulation                                |   | ✓ | 90         |
| KB           | Condensation Drain Holes - Plugged                |   | ✓ | 92         |
| KBO          | Condensation Drain Holes - Open                   |   | ✓ | 92         |
| KKV          | Terminal Box Sealed with Resin                    | ✓ |   | 93         |
| OL           | Totally Enclosed Non-Ventilated                   | ✓ |   | 94         |
| OL/H         | Totally Enclosed Non Ventilated without Fan Cover |   | ✓ | 94         |
| RD           | Canopy Drip Cover                                 | ✓ |   | 93         |
| RDD          | Double Fan Cover                                  | ✓ |   | 93         |
| RLS          | Motor Backstop                                    |   | ✓ | 95         |
| RS           | Round Motor Power Connectors                      |   | ✓ | 99         |
| SH           | Space Heater                                      |   | ✓ | 90         |
| TF           | Thermistor (PTC Resistor)                         |   | ✓ | 90         |
| TW           | Thermostat (Bimetallic Switch)                    |   | ✓ | 89         |
| WE           | 2nd Shaft Extension on Fan Side                   |   | ✓ | 94         |
| -            | IP65 Enclosure Protection                         | ✓ |   | 93         |
| -            | IP66 Enclosure Protection                         | ✓ |   | 16         |
| -            | Paint Coatings                                    | ✓ |   | 92         |

Additional information can be found in the M7000 catalog. Additional options may be available upon special request.





## Brake Selection

Each NORD motor may be supplied with a number of brake torque sizes and options. Each brake may be adjusted to different brake torque values and special needs. Additional information about brake sizing and selection may be found in the M7000 catalog or in the user manuals.

| Motor Size & Efficiency |                                       | Brake Size and Torque |        |        |        |
|-------------------------|---------------------------------------|-----------------------|--------|--------|--------|
| Frame Size              | PE                                    | Nm                    | BRE250 | BRE400 | BRE800 |
|                         |                                       | lb-in                 | 250    | 400    | 800    |
|                         |                                       | lb-ft                 | 2213   | 3540   | 7080   |
| 225                     | RP                                    |                       | Opt.   | Std.   |        |
| 225                     | SP                                    |                       | Opt.   | Std.   |        |
| 225                     | MP                                    |                       |        | Opt.   | Std.   |
| 250                     | WP                                    |                       |        | Opt.   | Std.   |
| Weight                  | kg                                    |                       | 32     | 50     | 53     |
|                         | lb                                    |                       | 71     | 110    | 117    |
| Inertia                 | kg-m <sup>2</sup> x 10 <sup>-3</sup>  |                       | 6.65   | 19.5   | 39     |
|                         | lb-ft <sup>2</sup> x 10 <sup>-3</sup> |                       | 158    | 463    | 926    |

Contact the NORD Engineering department for additional information regarding technical information on brakes and their options.

## Brake Options

| Abbreviation | Description   | M7000 Page |
|--------------|---|------------|
| ADJ          | Torque Adjustment - Brake torque may be adjusted at the factory   | 109        |
| HL           | Hand Release Lever - Manual hand release lever  | 115        |
| IR           | Current Sensing Relay - Fast brake engagement (stopping) without external control equipment                           | 117        |
| MIK          | Micro-Switch - Brake fitted with a micro-switch for sensing the brake state (released or engaged)                     | 116        |
| NRB1         | Quiet Brake Release - An o-ring is placed between the coil body and the armature plate for noise reduction            | 116        |
| NRB2         | Quiet Brake Motor Operation - An o-ring is placed between the carrier hub & the armature plate to prevent clattering. | 116        |
| RG           | Corrosion Protected Brake - Corrosion protected brake   | 115        |
| SR           | Dust & Corrosion Protected Brake - Dust & corrosion protected brake   | 115        |

## Brake Rectifier Options

| Abbreviation | Description   | Page |
|--------------|---|------|
| Rectifiers   | Most NORD brakes are provided with a rectifier that converts AC voltage to DC voltage. Rectifiers are used because most motors are AC powered, but brakes require DC power. | 119  |
| GHE          | Half Wave Rectifiers  | 125  |
| PMG          | Push Hybrid Rectifiers - External DC Switching*   | 128  |
| GVE          | Full Wave Rectifiers  | 124  |

\* The PMG rectifier is required when utilizing the larger 800 Nm (590 ft-lb) twin rotor brake. In order to prevent rapid wear the rectifier must be used to "overexcite" the brake release.

# Performance Data

## 40 - 75 hp Motors



Premium Efficient • Inverter duty • TEFC  
 Synchronous speed 1800rpm @ 60Hz • 4-pole • Three-phase  
 Voltages: 460 & 575V – 60Hz • 1.15 Service Factor  
 Continuous Duty • 40°C Ambient • up to 3300ft Elevation  
 Class B temperature rise • Class F insulation



| 60 HZ Premium Efficient (IE3) |                                |      |                                |                                  |          |   |                  |                                 |  |  |                 |                        |                              |            |
|-------------------------------|--------------------------------|------|--------------------------------|----------------------------------|----------|---|------------------|---------------------------------|--|--|-----------------|------------------------|------------------------------|------------|
| Motor Type                    | P <sub>n</sub> Full Load Power |      | n <sub>N</sub> Full-Load Speed | I <sub>n</sub> Full-Load Current |          | I <sub>a</sub> /I <sub>n</sub> Locked Rotor Current Ratio | NEMA Code Letter | T <sub>n</sub> Full-Load Torque | T <sub>a</sub> /T <sub>n</sub> Locked Rotor Torque Ratio | T <sub>k</sub> /T <sub>n</sub> Break Down Torque Ratio | pf Power Factor | η Full Load Efficiency | J <sub>m</sub> Rotor Inertia | Wt. Weight |
|                               | [hp]                           | [kW] |                                | [rpm]                            | 460V [A] |   |                  |                                 |  |  |                 |                        |                              |            |
| 225 RP/4                      | 40                             | 30   | 1785                           | 49.5                             | 39.6     | 890   | K                | 1412                            | 3.4  | 3.8  | 0.81            | 94.5                   | 11.63                        | 694        |
| 225 SP/4                      | 50                             | 37   | 1785                           | 59.7                             | 47.8     | 880   | K                | 1765                            | 3.0  | 3.7  | 0.82            | 94.6                   | 12.81                        | 728        |
| 225 MP/4                      | 60                             | 45   | 1785                           | 72.0                             | 57.6     | 910   | K                | 2118                            | 3.3  | 3.6  | 0.83            | 95.2                   | 15.90                        | 805        |
| 250 WP/4                      | 75                             | 55   | 1785                           | 84.4                             | 67.5     | 920   | J                | 2648                            | 2.9  | 3.2  | 0.86            | 95.4                   | 19.46                        | 882        |

Premium Efficient • Inverter duty • Induction motor • TEFC  
 Synchronous speed 1500rpm @ 50Hz • 4-pole • Three-phase  
 Voltages: 400V (380-420V) – 50Hz • 1.0 Service Factor  
 Continuous Duty • 40°C Ambient • up to 3300ft Elevation  
 Class B temperature rise • Class F insulation



| 50 HZ Premium Efficient (IE3) |                                |      |                                |                                  |          |   |                  |                                 |  |  |                 |                        |                              |            |
|-------------------------------|--------------------------------|------|--------------------------------|----------------------------------|----------|---|------------------|---------------------------------|--|--|-----------------|------------------------|------------------------------|------------|
| Motor Type                    | P <sub>n</sub> Full Load Power |      | n <sub>N</sub> Full-Load Speed | I <sub>n</sub> Full-Load Current |          | I <sub>a</sub> /I <sub>n</sub> Locked Rotor Current Ratio | NEMA Code Letter | T <sub>n</sub> Full-Load Torque | T <sub>a</sub> /T <sub>n</sub> Locked Rotor Torque Ratio | T <sub>k</sub> /T <sub>n</sub> Break Down Torque Ratio | pf Power Factor | η Full Load Efficiency | J <sub>m</sub> Rotor Inertia | Wt. Weight |
|                               | [hp]                           | [kW] |                                | [rpm]                            | 400V [A] |   |                  |                                 |  |  |                 |                        |                              |            |
| 225 RP/4                      | 40                             | 30   | 1485                           | 56.2                             | 780      | J   | 1707             | 3.0                             | 3.4  | 0.82   | 94.1            | 11.63                  | 694                          |            |
| 225 SP/4                      | 50                             | 37   | 1485                           | 68.2                             | 770      | J   | 2106             | 2.9                             | 3.2  | 0.83   | 94.1            | 12.81                  | 728                          |            |
| 225 MP/4                      | 60                             | 45   | 1485                           | 81.7                             | 800      | J   | 2561             | 3.0                             | 3.4  | 0.83   | 94.6            | 15.90                  | 805                          |            |
| 250 WP/4                      | 75                             | 55   | 1480                           | 96.1                             | 700      | H   | 3141             | 2.6                             | 2.8  | 0.87   | 94.6            | 19.46                  | 882                          |            |





# IEC B3 Foot Mounted Motor Dimensions

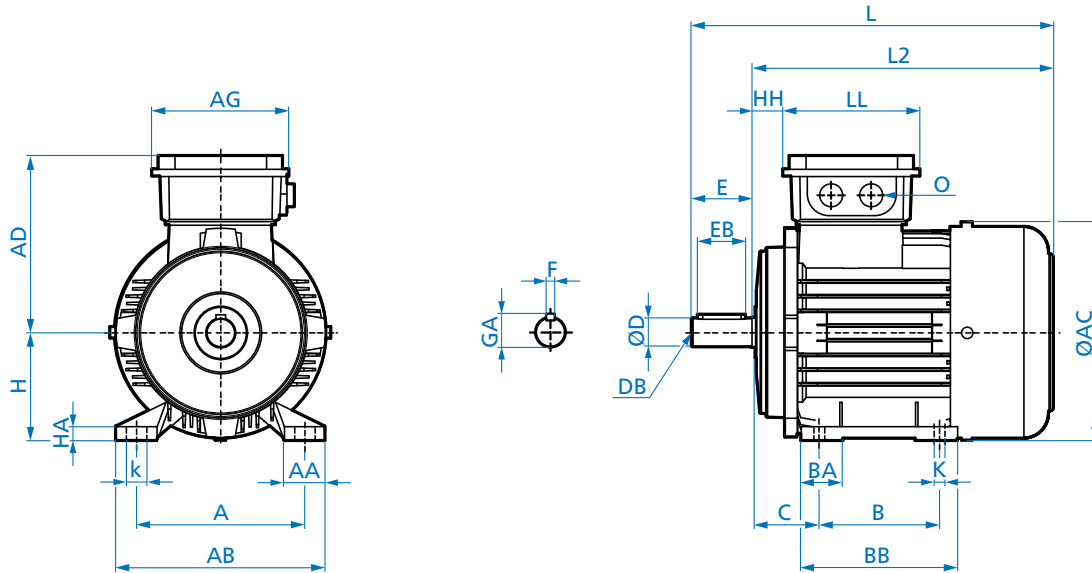

Dimensions

| Motor Frame | Efficiency | Overall |     |     | Feet |     |     |    |    |     |     |    |    |    |
|-------------|------------|---------|-----|-----|------|-----|-----|----|----|-----|-----|----|----|----|
|             |            | IE3     | L   | L2  | ØAC  | A   | B   | C  | AA | BA  | AB  | BB | k  | K  |
| 225         | SP         | 882     | 742 | 443 | 356  | 286 | 149 | 79 | 66 | 443 | 359 | 25 | 20 | 20 |
| 225         | MP         | 882     | 742 | 443 | 356  | 311 | 149 | 79 | 66 | 443 | 359 | 25 | 20 | 20 |

| Motor Frame | Efficiency | Shaft |                                       |          |     |     |    |    | Terminal Box |     |    |     |     |           |
|-------------|------------|-------|---------------------------------------|----------|-----|-----|----|----|--------------|-----|----|-----|-----|-----------|
|             |            | IE3   | ØD                                    | DB       | E   | EB  | GA | F  | H            | AD  | HH | LL  | AG  | O         |
| 225         | SP         | 60    | <sup>+0.030</sup> / <sub>+0.011</sub> | M20 X 42 | 140 | 125 | 64 | 18 | 225          | 347 | 94 | 245 | 245 | M50 X 1.5 |
| 225         | MP         | 60    | <sup>+0.030</sup> / <sub>+0.011</sub> | M20 X 42 | 140 | 125 | 64 | 18 | 225          | 347 | 94 | 245 | 245 | M50 X 1.5 |

# IEC B3 Foot Mounted Motor Option Dimensions



## Option WE - 2nd Shaft Extension

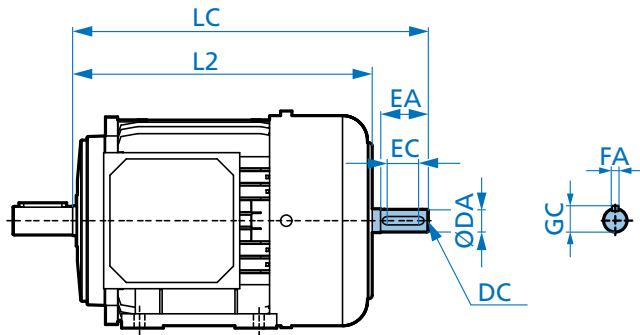

Dimensions

## Option RD - Canopy Drip Cover

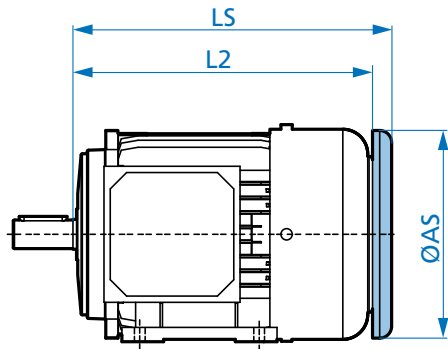

## Option RDD - Double Fan Cover

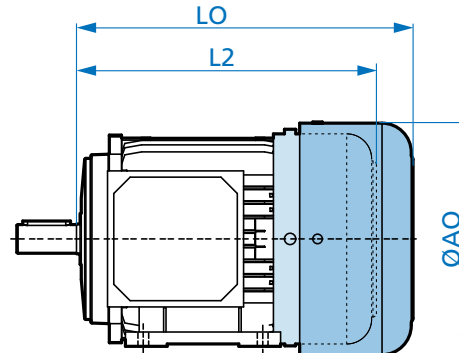

| Motor Frame | Efficiency IE3 | L2  | LC  | WE                                       |     |     |          |      |    | RD    |     | RDD |     |
|-------------|----------------|-----|-----|--|-----|-----|----------|------|----|-------|-----|-----|-----|
|             |                |     |     | DA                                       | EA  | EC  | DC       | GC   | FA | LS    | ØAS | LO  | ØAO |
| 225         | SP             | 742 | 862 | 55 <sup>+0.030</sup> / <sub>+0.011</sub> | 110 | 100 | M20 X 42 | 59.3 | 16 | 828.5 | 348 | 826 | 519 |
| 225         | MP             | 742 | 862 | 55 <sup>+0.030</sup> / <sub>+0.011</sub> | 110 | 100 | M20 X 42 | 59.3 | 16 | 828.5 | 348 | 826 | 519 |



# IEC B3 Foot Mounted Motor Option Dimensions

## Option IG - Incremental Encoder

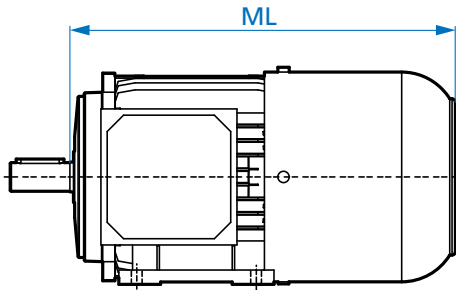

## Option F - Forced Cooling Fan

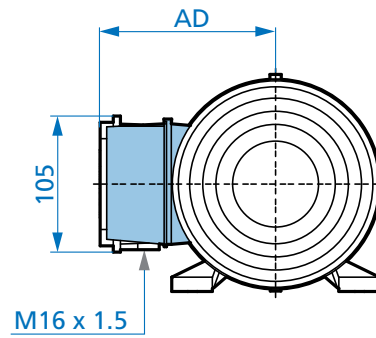
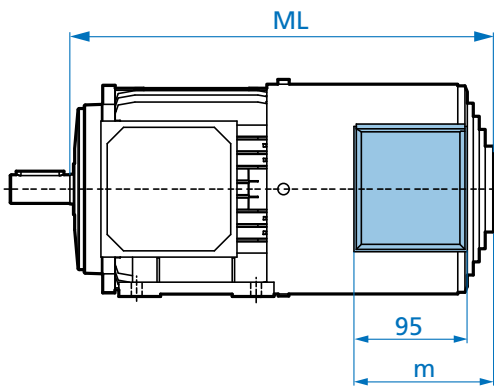

## Option IG-F - Incremental Encoder & Forced Cooling Fan

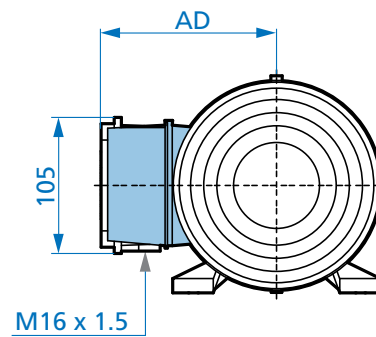
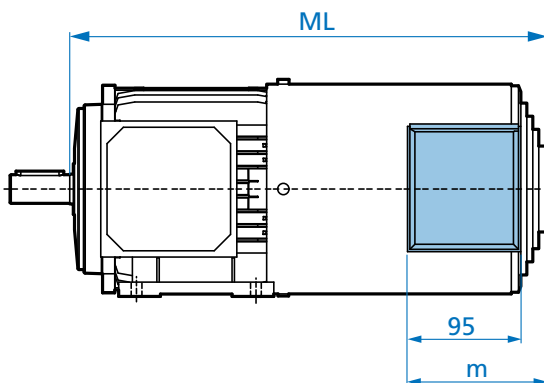

Dimensions

| Motor Frame | Efficiency IE3 | IG  |       | F   |       | IG-F   |     |       |
|-------------|----------------|-----|-------|-----|-------|--------|-----|-------|
|             |                | ML  | ML    | m   | AD    | ML     | m   | AS    |
| 225         | SP             | 809 | 942.5 | 144 | 249.5 | 1032.5 | 144 | 249.5 |
| 225         | MP             | 809 | 942.5 | 144 | 249.5 | 1032.5 | 144 | 249.5 |

# IEC B3 Foot Mounted Brakemotor Dimensions



Standard Brakemotor

Dimensions

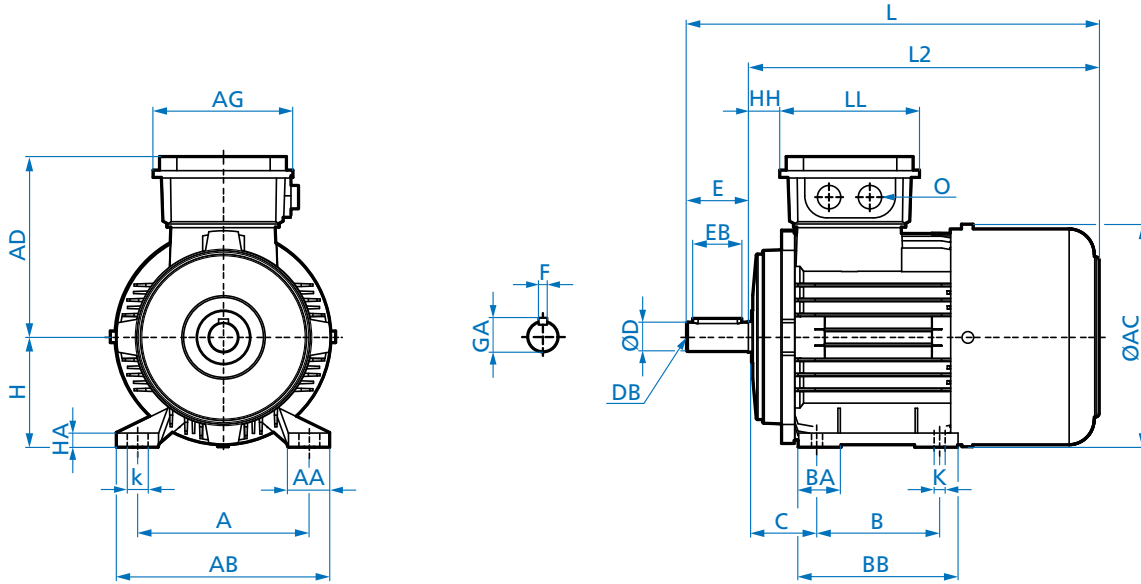

| Motor Frame | Efficiency IE3 | BRE Size | Overall |     |     | Feet |     |     |    |    |     |     |    |    |    |
|-------------|----------------|----------|---------|-----|-----|------|-----|-----|----|----|-----|-----|----|----|----|
|             |                |          | L       | L2  | ØAC | A    | B   | C   | AA | BA | AB  | BB  | k  | K  | HA |
| 225         | SP             | 400      | 1062    | 922 | 443 | 356  | 286 | 149 | 79 | 66 | 443 | 359 | 25 | 20 | 20 |
| 225         | MP             | 400      | 1062    | 922 | 443 | 356  | 311 | 149 | 79 | 66 | 443 | 359 | 25 | 20 | 20 |

| Motor Frame | Efficiency IE3 | BRE Size | Shaft                                  |          |     |     |    |    | Terminal Box |     |    |     |     |           |
|-------------|----------------|----------|--|----------|-----|-----|----|----|--------------|-----|----|-----|-----|-----------|
|             |                |          | ØD                                     | DB       | E   | EB  | GA | F  | H            | AD  | HH | LL  | AG  | O         |
| 225         | SP             | 400      | 60 <sup>+0.030</sup> <sub>+0.011</sub> | M20 X 42 | 140 | 125 | 64 | 18 | 225          | 347 | 94 | 245 | 245 | M50 X 1.5 |
| 225         | MP             | 400      | 60 <sup>+0.030</sup> <sub>+0.011</sub> | M20 X 42 | 140 | 125 | 64 | 18 | 225          | 347 | 94 | 245 | 245 | M50 X 1.5 |





# IEC B3 Foot Mounted Brakemotor Option Dimensions

## Option WE - 2nd Shaft Extension

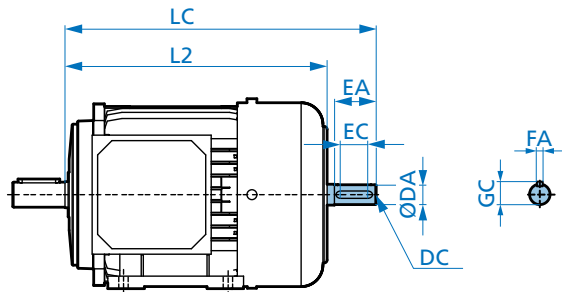

## Option RD - Canopy Drip Cover

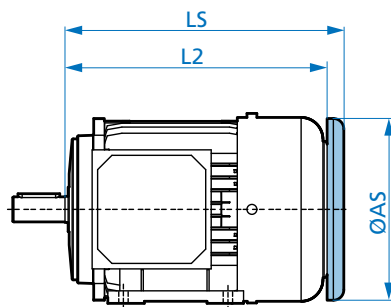

## Option RDD - Double Fan Cover

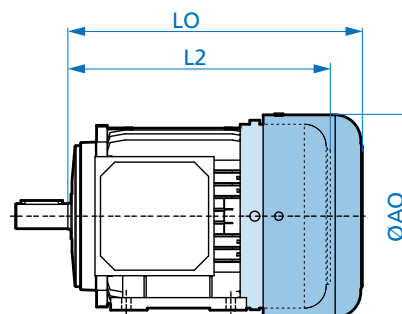

Dimensions

| Motor Frame | Efficiency IE3 | BRE | L2  | WE   |  |     |     |          |    |    | RD     |     | RDD  |     |
|-------------|----------------|-----|-----|------|--|-----|-----|----------|----|----|--------|-----|------|-----|
|             |                |     |     | LC   | DA                                       | EA  | EC  | DC       | GC | FA | LS     | ØAS | LO   | ØAO |
| 225         | SP             | 400 | 922 | 1042 | 55 <sup>+0.030</sup> / <sub>+0.011</sub> | 110 | 100 | M20 X 42 | 59 | 16 | 1008.5 | 348 | 1006 | 519 |
| 225         | MP             | 400 | 922 | 1042 | 55 <sup>+0.030</sup> / <sub>+0.011</sub> | 110 | 100 | M20 X 42 | 59 | 16 | 1008.5 | 348 | 1006 | 519 |

# IEC B3 Foot Mounted Brakemotor Option Dimensions



## Option IG - Incremental Encoder

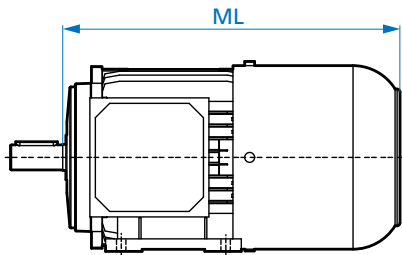

## Option F - Forced Cooling Fan

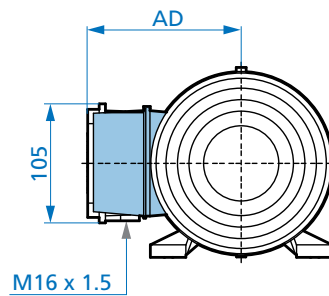
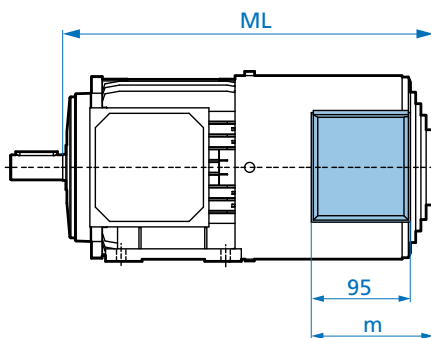

## Option IG-F - Incremental Encoder & Forced Cooling Fan

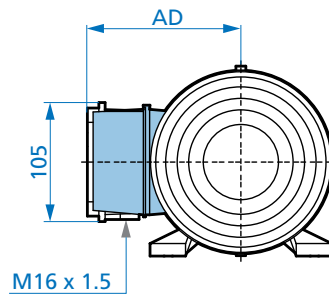
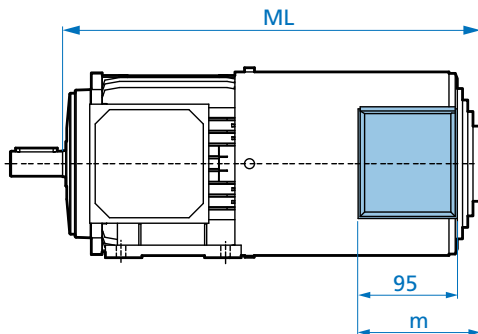

Dimensions

| Motor Frame | Efficiency |     | IG ML | ML     | F m | AD    | ML     | IG-F m | ØAS   |
|-------------|------------|-----|-------|--------|-----|-------|--------|--------|-------|
|             | IE3        | BRE |       |        |     |       |        |        |       |
| 225         | SP         | 400 | 989   | 1112.5 | 144 | 249.5 | 1202.5 | 144    | 249.5 |
| 225         | MP         | 400 | 989   | 1112.5 | 144 | 249.5 | 1202.5 | 144    | 249.5 |



# IEC B5 Flange Mounted Motor Dimensions

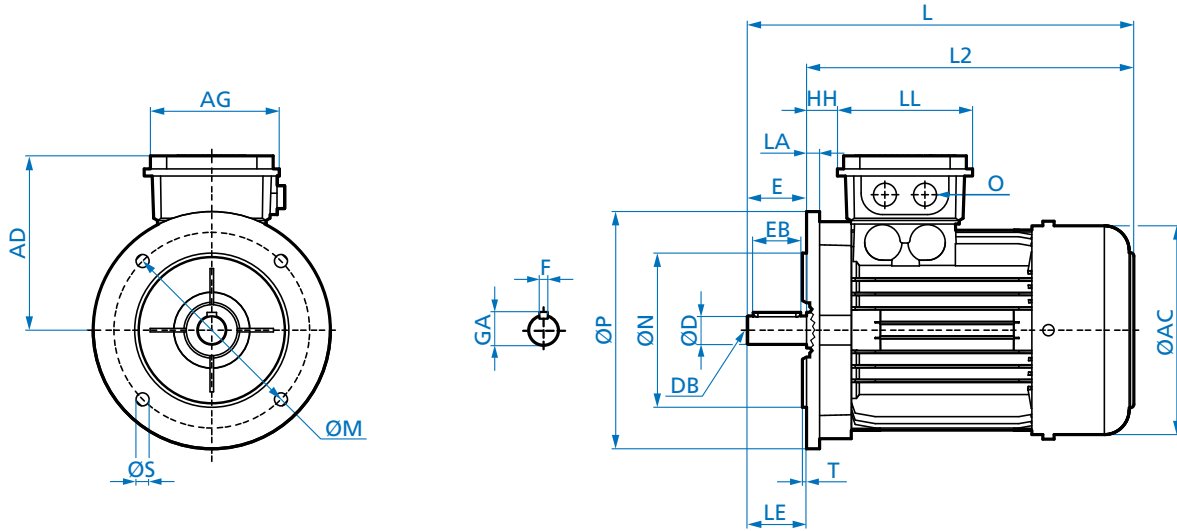

Dimensions

| Motor Frame | Efficiency IE3 | Flange Size | Overall |     |     | Mounting Flange |   |     |   |    |      |
|-------------|----------------|-------------|---------|-----|-----|-----------------|---|-----|---|----|------|
|             |                |             | L       | L2  | ØAC | M               | N                                       | P   | T | LA | S    |
| 225         | SP             | A450        | 882     | 742 | 443 | 400             | 350 <sup>+0.000</sup> <sub>-0.036</sub> | 450 | 5 | 20 | 17.5 |
| 225         | MP             | A450        | 882     | 742 | 443 | 400             | 350 <sup>+0.000</sup> <sub>-0.036</sub> | 450 | 5 | 20 | 17.5 |

| Motor Frame | Efficiency IE3 | Flange Size | Shaft                                  |          |     |     |     |    |    | Terminal Box |    |     |     |           |
|-------------|----------------|-------------|--|----------|-----|-----|-----|----|----|--------------|----|-----|-----|-----------|
|             |                |             | ØD                                     | DB       | E   | LE  | EB  | GA | F  | AD           | HH | LL  | AG  | O         |
| 225         | SP             | A450        | 60 <sup>+0.030</sup> <sub>+0.011</sub> | M20 X 42 | 140 | 140 | 125 | 64 | 18 | 347          | 94 | 245 | 245 | M50 X 1.5 |
| 225         | MP             | A450        | 60 <sup>+0.030</sup> <sub>+0.011</sub> | M20 X 42 | 140 | 140 | 125 | 64 | 18 | 347          | 94 | 245 | 245 | M50 X 1.5 |

# IEC B5 Flange Mounted Motor Option Dimensions



## Option WE - 2nd Shaft Extension

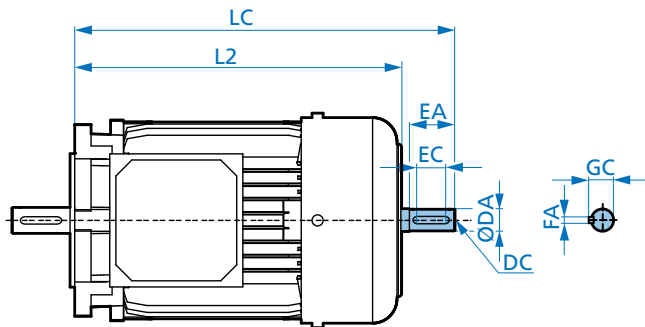

Dimensions

## Option RD - Canopy Drip Cover

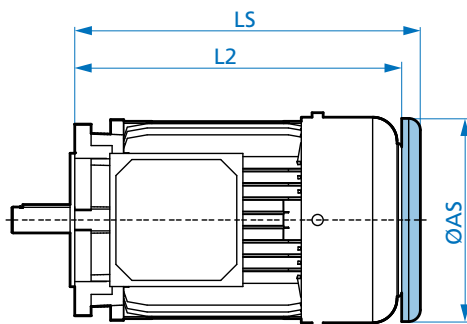

## Option RDD - Double Fan Cover

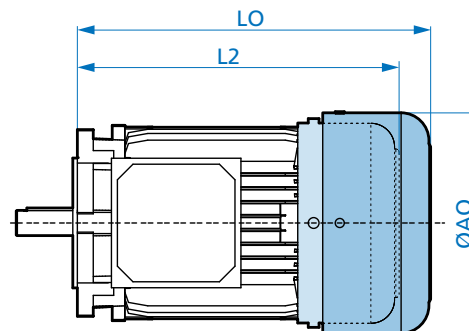

| Motor Frame | Efficiency | L2  | WE  |  |     |     |          |      |    |       | RD  |     | RDD |  |
|-------------|------------|-----|-----|--|-----|-----|----------|------|----|-------|-----|-----|-----|--|
|             |            |     | LC  | ØDA                                    | EA  | EC  | DC       | GC   | FA | LS    | ØAS | LO  | ØAO |  |
| 225         | SP         | 742 | 862 | 55 <sup>+0.030</sup> <sub>+0.011</sub> | 110 | 100 | M20 X 42 | 59.3 | 16 | 828.5 | 348 | 826 | 519 |  |
| 225         | MP         | 742 | 862 | 55 <sup>+0.030</sup> <sub>+0.011</sub> | 110 | 100 | M20 X 42 | 59.3 | 16 | 828.5 | 348 | 826 | 519 |  |





# IEC B5 Flange Mounted Motor Option Dimensions

## Option IG - Incremental Encoder

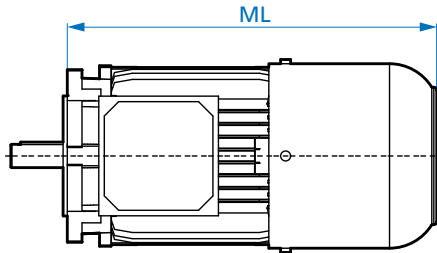

## Option F - Forced Cooling Fan

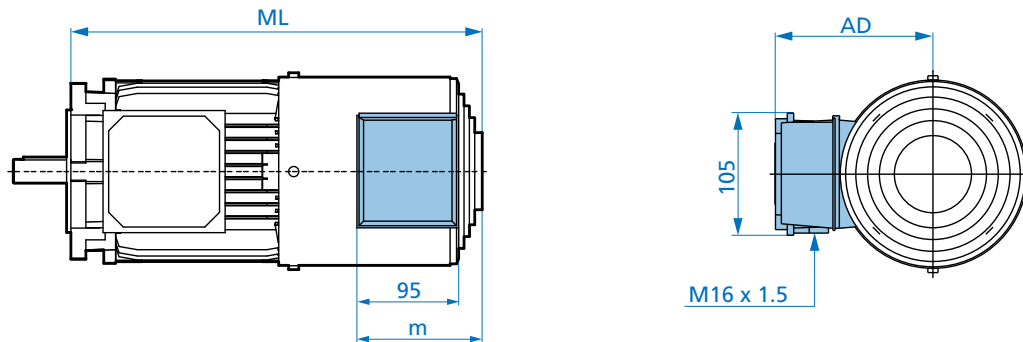

## Option IG-F - Incremental Encoder & Forced Cooling Fan

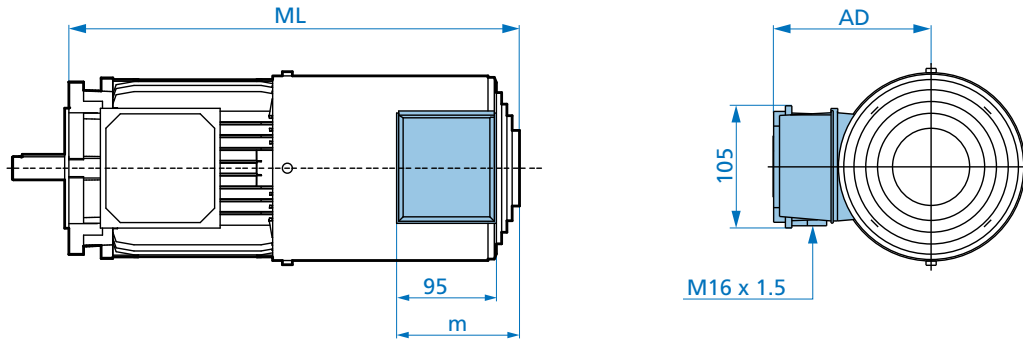

Dimensions

| Motor Frame | Efficiency IE3 | IG  |       | F   |       | IG-F   |     |       |
|-------------|----------------|-----|-------|-----|-------|--------|-----|-------|
|             |                | ML  | ML    | m   | AD    | ML     | m   | ØAS   |
| 225         | SP             | 809 | 942.5 | 144 | 249.5 | 1032.5 | 144 | 249.5 |
| 225         | MP             | 809 | 942.5 | 144 | 249.5 | 1032.5 | 144 | 249.5 |

# IEC B5 Flange Mounted Brakemotor Dimensions



Dimensions

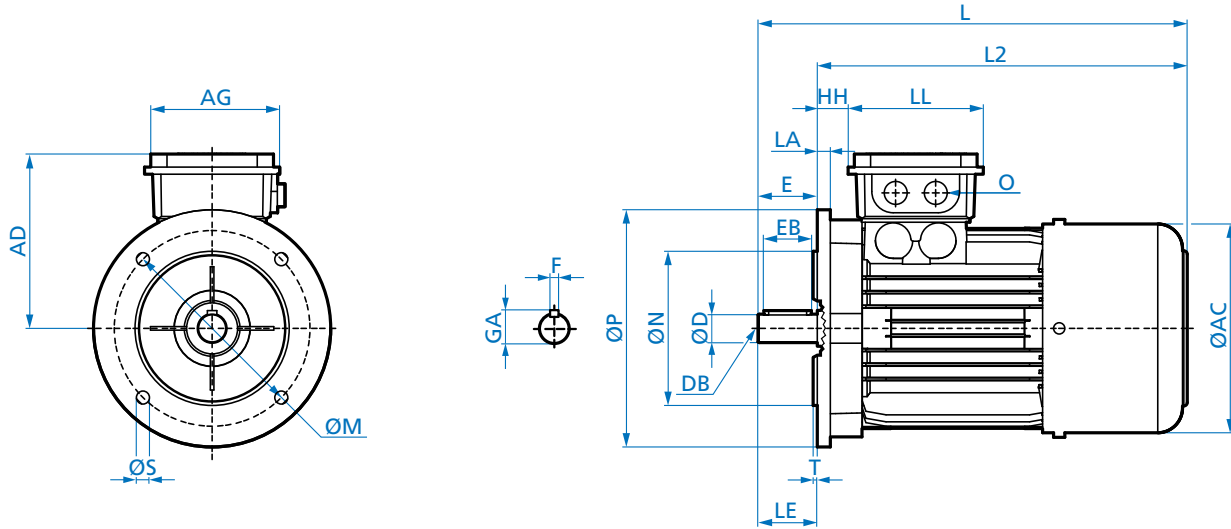

| Motor Frame | Efficiency IE3 | Flange Size | BRE | Overall |     |     | Mounting Flange |     |                                     |     |    |    |      |
|-------------|----------------|-------------|-----|---------|-----|-----|-----------------|-----|-------------------------------------|-----|----|----|------|
|             |                |             |     | L       | L2  | ØAC | M               | N   | P                                   | T   | LA | S  |      |
| 225         | SP             | A450        | 400 | 1062    | 922 | 443 | 400             | 350 | <sup>+0.000</sup> <sub>-0.036</sub> | 450 | 5  | 20 | 17.5 |
| 225         | MP             | A450        | 400 | 1062    | 922 | 443 | 400             | 350 | <sup>+0.000</sup> <sub>-0.036</sub> | 450 | 5  | 20 | 17.5 |

| Motor Frame | Efficiency IE3 | Flange Size | BRE | Shaft |                                     |          |     |     |     |    | Terminal Box |     |    |     |     |           |
|-------------|----------------|-------------|-----|-------|-------------------------------------|----------|-----|-----|-----|----|--------------|-----|----|-----|-----|-----------|
|             |                |             |     | ØD    | DB                                  | E        | LE  | EB  | GA  | F  | AD           | HH  | LL | AG  | O   |           |
| 225         | SP             | A450        | 400 | 60    | <sup>+0.030</sup> <sub>+0.011</sub> | M20 X 42 | 140 | 140 | 125 | 64 | 18           | 347 | 94 | 245 | 245 | M50 X 1.5 |
| 225         | MP             | A450        | 400 | 60    | <sup>+0.030</sup> <sub>+0.011</sub> | M20 X 42 | 140 | 140 | 125 | 64 | 18           | 347 | 94 | 245 | 245 | M50 X 1.5 |



# IEC B5 Flange Mounted Brakemotor Option Dimensions

Option WE - 2nd Shaft Extension

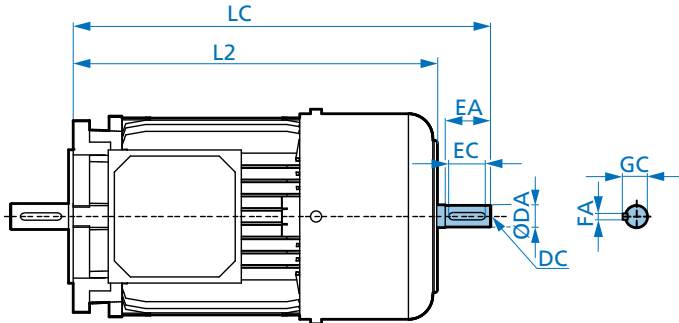

Option RD - Canopy Drip Cover

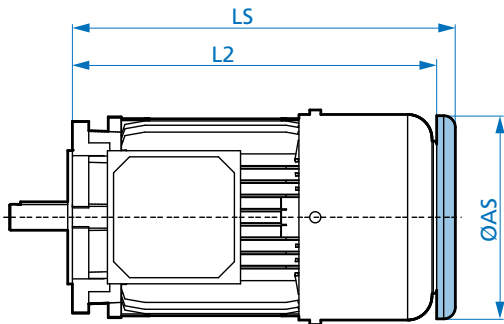

Option RDD - Double Fan Cover

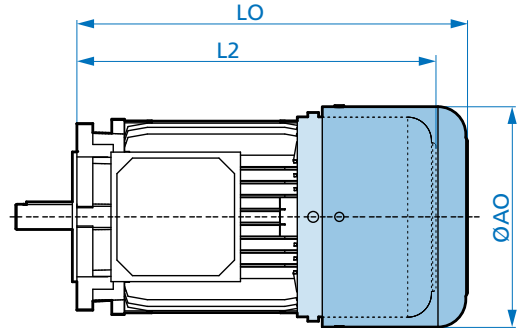

Dimensions

| Motor Frame | Efficiency IE3 | BRE | L2  | WE   |  |     |     |          |      |    |        | RD  |      | RDD |  |
|-------------|----------------|-----|-----|------|--|-----|-----|----------|------|----|--------|-----|------|-----|--|
|             |                |     |     | LC   | ØDA                                      | EA  | EC  | DC       | GC   | FA | LS     | ØAS | LO   | ØAO |  |
| 225         | SP             | 400 | 922 | 1042 | 55 <sup>+0.030</sup> / <sub>+0.011</sub> | 110 | 100 | M20 X 42 | 59.3 | 16 | 1008.5 | 348 | 1006 | 519 |  |
| 225         | MP             | 400 | 922 | 1042 | 55 <sup>+0.030</sup> / <sub>+0.011</sub> | 110 | 100 | M20 X 42 | 59.3 | 16 | 1008.5 | 348 | 1006 | 519 |  |

# IEC B5 Flange Mounted Brakemotor Option Dimensions



## Option IG - Incremental Encoder

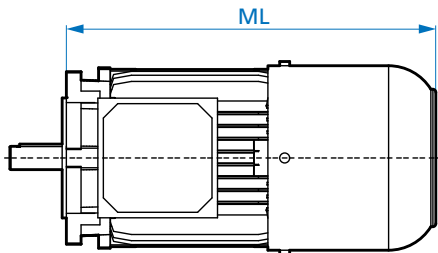

## Option F - Forced Cooling Fan

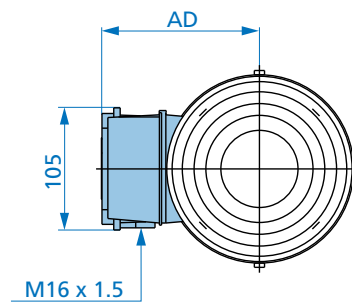
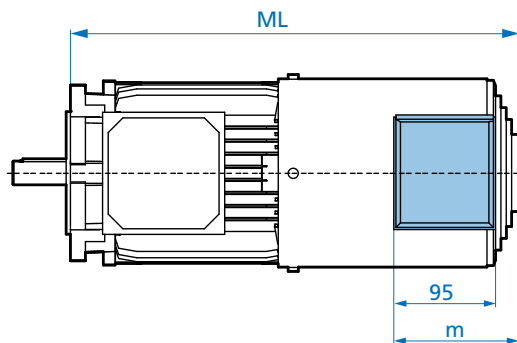

## Option IG-F - Incremental Encoder & Forced Cooling Fan

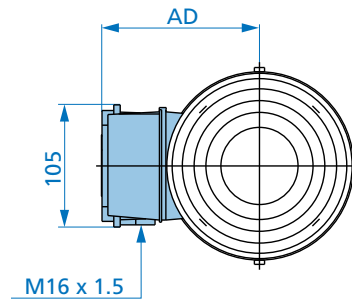
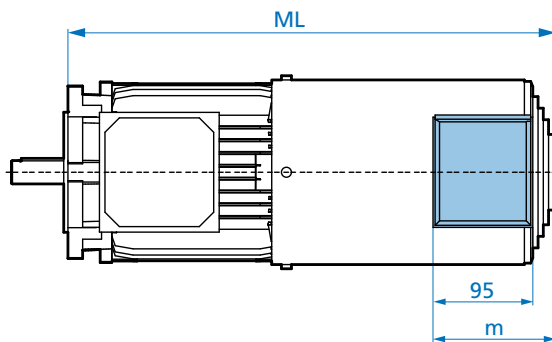

Dimensions

| mm<br>Motor<br>Frame | Efficiency<br>PE | BRE | IG<br>ML | ML     | F<br>m | AD    | ML     | IG F<br>m | AD    |
|----------------------|------------------|-----|----------|--------|--------|-------|--------|-----------|-------|
| 225                  | SP               | 400 | 989      | 1112.5 | 144    | 249.5 | 1202.5 | 144       | 249.5 |
| 250                  | MP               | 400 | 989      | 1112.5 | 144    | 249.5 | 1202.5 | 144       | 249.5 |



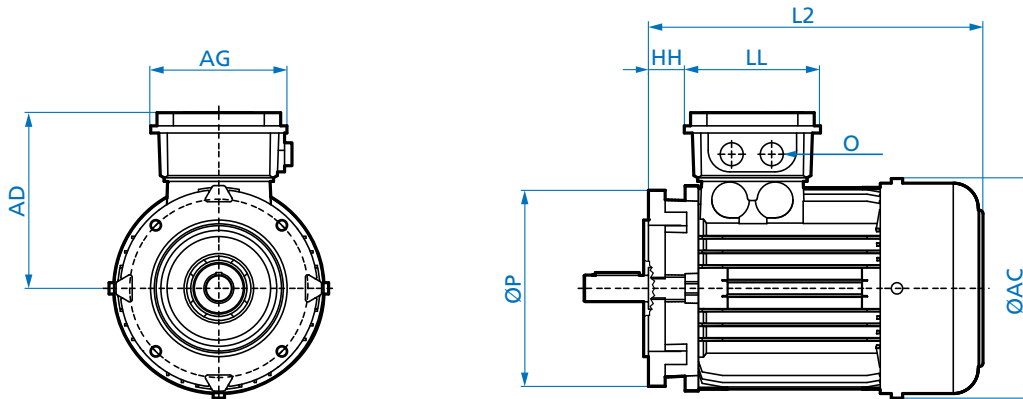

| inch<br>Motor<br>Frame | Efficiency<br>PE | Overall |       | Flange<br>ØP | Terminal Box |      |      |      |            |
|------------------------|------------------|---------|-------|--------------|--------------|------|------|------|------------|
|                        |                  | L2      | ØAC   |              | AD           | HH   | LL   | AG   | O<br>(NPT) |
| 225                    | RP               | 29.21   | 17.44 | 11.81        | 13.66        | 3.70 | 9.65 | 9.65 | 1-1/2" NPT |
| 225                    | RP               | 29.21   | 17.44 | 13.78        | 13.66        | 3.70 | 9.65 | 9.65 | 1-1/2" NPT |
| 225                    | SP               | 29.21   | 17.44 | 13.78        | 13.66        | 3.70 | 9.65 | 9.65 | 1-1/2" NPT |
| 225                    | MP               | 29.21   | 17.44 | 13.78        | 13.66        | 3.70 | 9.65 | 9.65 | 1-1/2" NPT |
| 250                    | WP               | 29.21   | 17.44 | 17.72        | 13.66        | 3.70 | 9.65 | 9.65 | 2" NPT     |

| mm<br>Motor<br>Frame | Efficiency<br>PE | Overall |     | Flange<br>ØP | Terminal Box |    |     |     |            |
|----------------------|------------------|---------|-----|--------------|--------------|----|-----|-----|------------|
|                      |                  | L2      | ØAC |              | AD           | HH | LL  | AG  | O<br>(NPT) |
| 225                  | RP               | 742     | 443 | 300          | 347          | 94 | 245 | 245 | M50 X 1.5  |
| 225                  | RP               | 742     | 443 | 350          | 347          | 94 | 245 | 245 | M50 X 1.5  |
| 225                  | SP               | 742     | 443 | 350          | 347          | 94 | 245 | 245 | M50 X 1.5  |
| 225                  | MP               | 742     | 443 | 350          | 347          | 94 | 245 | 245 | M50 X 1.5  |
| 250                  | WP               | 742     | 443 | 450          | 347          | 94 | 245 | 245 | M63 X 1.5  |

# Integral Motor Option Dimensions



## Option WE - 2nd Shaft Extension

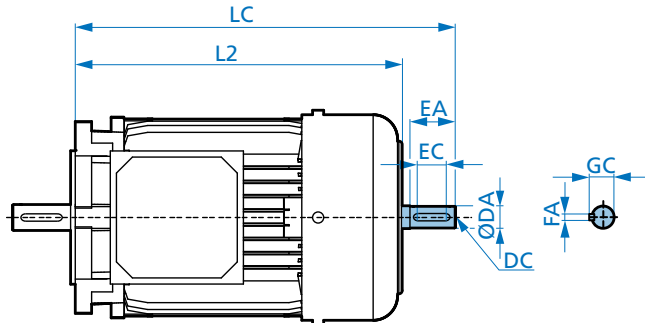

## Option RD - Canopy Drip Cover

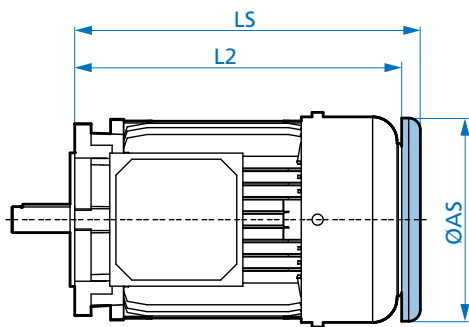

## Option RDD - Double Fan Cover

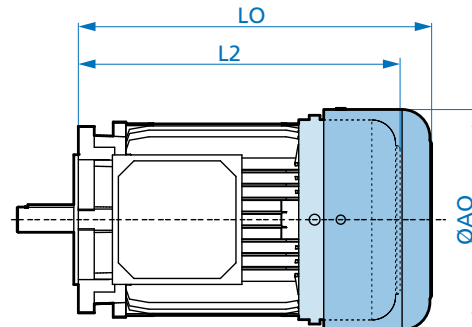

Dimensions

| inch<br>Motor<br>Frame | Efficiency<br>PE | L2    | LC    | DA   | WE   |      |          |      |      |       | RD    |       | RDD   |  |
|------------------------|------------------|-------|-------|--|------|------|----------|------|------|-------|-------|-------|-------|--|
|                        |                  |       |       |  | EA   | EC   | DC       | GC   | FA   | LS    | øAS   | LO    | øAO   |  |
| 225                    | RP               | 29.21 | 33.94 | 2.17<br><small>+0.0012<br/>+0.0004</small> | 4.33 | 3.94 | M20 X 42 | 2.33 | 0.63 | 32.62 | 13.70 | 32.52 | 20.43 |  |
| 225                    | RP               | 29.21 | 33.94 | 2.17<br><small>+0.0012<br/>+0.0004</small> | 4.33 | 3.94 | M20 X 42 | 2.33 | 0.63 | 32.62 | 13.70 | 32.52 | 20.43 |  |
| 225                    | SP               | 29.21 | 33.94 | 2.17<br><small>+0.0012<br/>+0.0004</small> | 4.33 | 3.94 | M20 X 42 | 2.33 | 0.63 | 32.62 | 13.70 | 32.52 | 20.43 |  |
| 225                    | MP               | 29.21 | 33.94 | 2.17<br><small>+0.0012<br/>+0.0004</small> | 4.33 | 3.94 | M20 X 42 | 2.33 | 0.63 | 32.62 | 13.70 | 32.52 | 20.43 |  |
| 250                    | WP               | 29.21 | 35.12 | 2.36<br><small>+0.0012<br/>+0.0004</small> | 5.51 | 4.92 | M20 X 42 | 2.54 | 0.71 | 32.62 | 13.70 | 32.52 | 20.43 |  |

| mm<br>Motor<br>Frame | Efficiency<br>PE | L2  | LC  | DA                                     | WE  |     |          |      |    |       | RD  |     | RDD |  |
|----------------------|------------------|-----|-----|--|-----|-----|----------|------|----|-------|-----|-----|-----|--|
|                      |                  |     |     |  | EA  | EC  | DC       | GC   | FA | LS    | øAS | LO  | øAO |  |
| 225                  | RP               | 742 | 862 | 55<br><small>+0.030<br/>+0.011</small> | 110 | 100 | M20 X 42 | 59.3 | 16 | 828.5 | 348 | 826 | 519 |  |
| 225                  | RP               | 742 | 862 | 55<br><small>+0.030<br/>+0.011</small> | 110 | 100 | M20 X 42 | 59.3 | 16 | 828.5 | 348 | 826 | 519 |  |
| 225                  | SP               | 742 | 862 | 55<br><small>+0.030<br/>+0.011</small> | 110 | 100 | M20 X 42 | 59.3 | 16 | 828.5 | 348 | 826 | 519 |  |
| 225                  | MP               | 742 | 862 | 55<br><small>+0.030<br/>+0.011</small> | 110 | 100 | M20 X 42 | 59.3 | 16 | 828.5 | 348 | 826 | 519 |  |
| 250                  | WP               | 742 | 892 | 60<br><small>+0.030<br/>+0.011</small> | 140 | 125 | M20 X 42 | 64.4 | 18 | 828.5 | 348 | 826 | 519 |  |



# Integral Motor Option Dimensions

## Option IG - Incremental Encoder

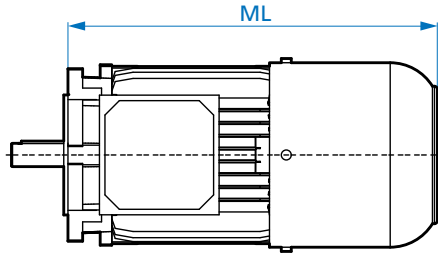

## Option F - Forced Cooling Fan

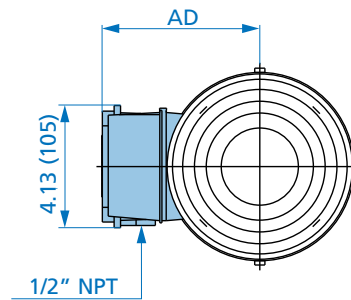
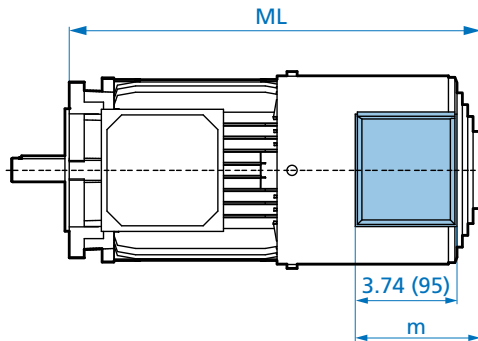

## Option IG-F - Incremental Encoder & Forced Cooling Fan

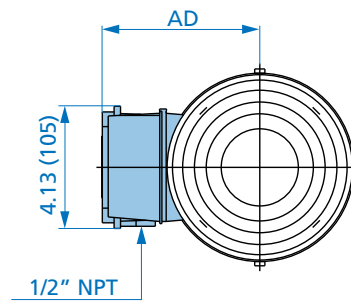
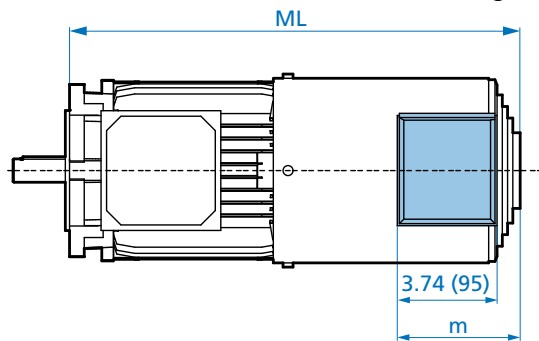

Dimensions

| inch<br>Motor<br>Frame | Efficiency<br>PE | IG<br>ML | ML    | F<br>m | AD   | ML    | IG F<br>m | AD   |
|------------------------|------------------|----------|-------|--------|------|-------|-----------|------|
| 225                    | RP               | 31.85    | 37.11 | 5.67   | 9.82 | 40.65 | 5.67      | 9.82 |
| 225                    | RP               | 31.85    | 37.11 | 5.67   | 9.82 | 40.65 | 5.67      | 9.82 |
| 225                    | SP               | 31.85    | 37.11 | 5.67   | 9.82 | 40.65 | 5.67      | 9.82 |
| 225                    | MP               | 31.85    | 37.11 | 5.67   | 9.82 | 40.65 | 5.67      | 9.82 |
| 250                    | WP               | 31.85    | 37.11 | 5.67   | 9.82 | 40.65 | 5.67      | 9.82 |

| mm<br>Motor<br>Frame | Efficiency<br>PE | IG<br>ML | ML    | F<br>m | AD    | ML     | IG F<br>m | AD    |
|----------------------|------------------|----------|-------|--------|-------|--------|-----------|-------|
| 225                  | RP               | 809      | 942.5 | 144    | 249.5 | 1032.5 | 144       | 249.5 |
| 225                  | RP               | 809      | 942.5 | 144    | 249.5 | 1032.5 | 144       | 249.5 |
| 225                  | SP               | 809      | 942.5 | 144    | 249.5 | 1032.5 | 144       | 249.5 |
| 225                  | MP               | 809      | 942.5 | 144    | 249.5 | 1032.5 | 144       | 249.5 |
| 250                  | WP               | 809      | 942.5 | 144    | 249.5 | 1032.5 | 144       | 249.5 |

# Integral Brakemotor Dimensions



Dimensions

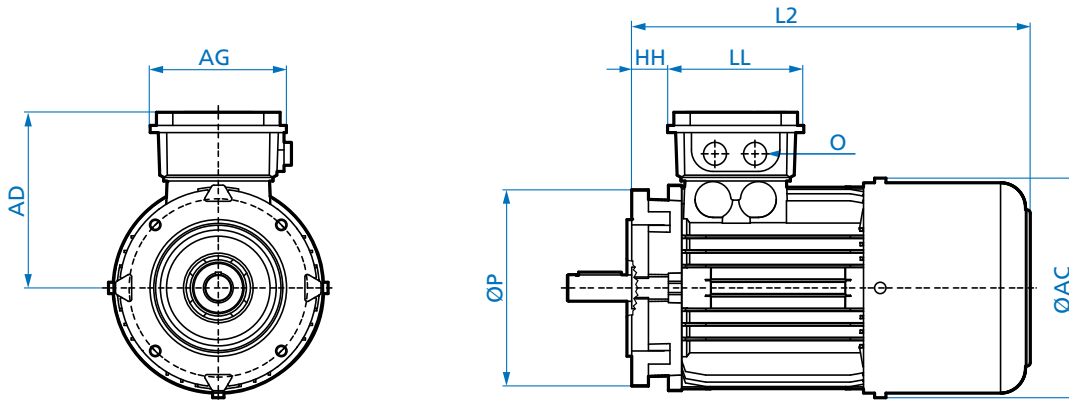

| inch<br>Motor<br>Frame | Efficiency |     | Overall |       | Flange<br>ØP | Terminal Box |      |      |      |            |
|------------------------|------------|-----|---------|-------|--------------|--------------|------|------|------|------------|
|                        | PE         | BRE | L2      | ØAC   |              | AD           | HH   | LL   | AG   | O<br>(NPT) |
| 225                    | RP         | 400 | 36.30   | 17.44 | 11.81        | 13.66        | 3.70 | 9.65 | 9.65 | 1-1/2" NPT |
| 225                    | RP         | 400 | 36.30   | 17.44 | 13.78        | 13.66        | 3.70 | 9.65 | 9.65 | 1-1/2" NPT |
| 225                    | SP         | 400 | 36.30   | 17.44 | 13.78        | 13.66        | 3.70 | 9.65 | 9.65 | 1-1/2" NPT |
| 225                    | MP         | 800 | 36.30   | 17.44 | 13.78        | 13.66        | 3.70 | 9.65 | 9.65 | 1-1/2" NPT |
| 250                    | WP         | 800 | 36.30   | 17.44 | 17.72        | 13.66        | 3.70 | 9.65 | 9.65 | 2" NPT     |

| mm<br>Motor<br>Frame | Efficiency |     | Overall |     | Flange<br>ØP | Terminal Box |    |     |     |            |
|----------------------|------------|-----|---------|-----|--------------|--------------|----|-----|-----|------------|
|                      | PE         | BRE | L2      | ØAC |              | AD           | HH | LL  | AG  | O<br>(NPT) |
| 225                  | RP         | 400 | 922     | 443 | 300          | 347          | 94 | 245 | 245 | M50 X 1.5  |
| 225                  | RP         | 400 | 922     | 443 | 350          | 347          | 94 | 245 | 245 | M50 X 1.5  |
| 225                  | SP         | 400 | 922     | 443 | 350          | 347          | 94 | 245 | 245 | M50 X 1.5  |
| 225                  | MP         | 800 | 922     | 443 | 350          | 347          | 94 | 245 | 245 | M50 X 1.5  |
| 250                  | WP         | 800 | 922     | 443 | 450          | 347          | 94 | 245 | 245 | M63 X 1.5  |



# Integral Brakemotor Option Dimensions

## Option WE - 2nd Shaft Extension

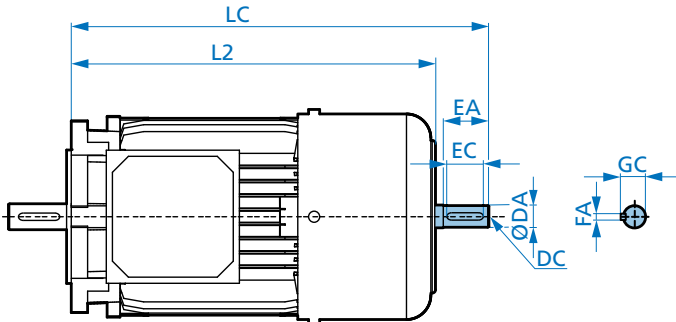

## Option RD - Canopy Drip Cover

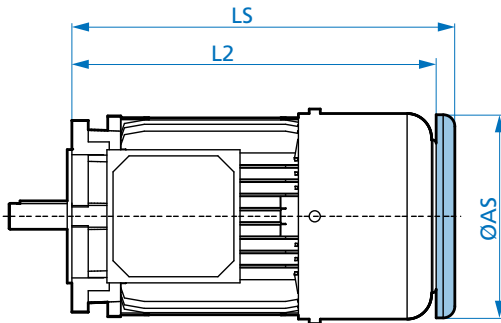

## Option RDD - Double Fan Cover

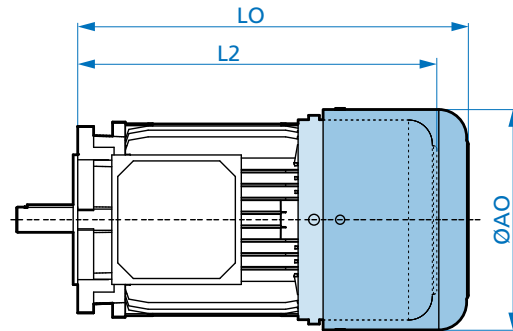

Dimensions

| inch<br>Motor<br>Frame | Efficiency<br>PE | BRE | L2    | LC    | DA   | WE                                    |      |      |          |      | RD   |       | RDD   |       |       |
|------------------------|------------------|-----|-------|-------|------|---------------------------------------|------|------|----------|------|------|-------|-------|-------|-------|
|                        |                  |     |       |       |      | EA                                    | EC   | DC   | GC       | FA   | LS   | øAS   | LO    | øAO   |       |
| 225                    | RP               | 400 | 36.30 | 41.02 | 2.17 | <sup>+0.0012</sup> <sub>-0.0004</sub> | 4.33 | 3.94 | M20 X 42 | 2.33 | 0.63 | 39.70 | 13.70 | 39.61 | 20.43 |
| 225                    | RP               | 400 | 36.30 | 41.02 | 2.17 | <sup>+0.0012</sup> <sub>-0.0004</sub> | 4.33 | 3.94 | M20 X 42 | 2.33 | 0.63 | 39.70 | 13.70 | 39.61 | 20.43 |
| 225                    | SP               | 400 | 36.30 | 41.02 | 2.17 | <sup>+0.0012</sup> <sub>-0.0004</sub> | 4.33 | 3.94 | M20 X 42 | 2.33 | 0.63 | 39.70 | 13.70 | 39.61 | 20.43 |
| 225                    | MP               | 800 | 36.30 | 41.02 | 2.17 | <sup>+0.0012</sup> <sub>-0.0004</sub> | 4.33 | 3.94 | M20 X 42 | 2.33 | 0.63 | 39.70 | 13.70 | 39.61 | 20.43 |
| 225                    | WP               | 800 | 36.30 | 42.20 | 2.36 | <sup>+0.0012</sup> <sub>-0.0004</sub> | 5.51 | 4.92 | M20 X 42 | 2.54 | 0.71 | 39.70 | 13.70 | 39.61 | 20.43 |

| mm<br>Motor<br>Frame | Efficiency<br>PE | BRE | L2  | LC   | DA | WE                                  |     |     |          |      | RD |        | RDD |      |     |
|----------------------|------------------|-----|-----|------|----|-------------------------------------|-----|-----|----------|------|----|--------|-----|------|-----|
|                      |                  |     |     |      |    | EA                                  | EC  | DC  | GC       | FA   | LS | øAS    | LO  | øAO  |     |
| 225                  | RP               | 400 | 922 | 1042 | 55 | <sup>+0.030</sup> <sub>+0.011</sub> | 110 | 100 | M20 X 42 | 59.3 | 16 | 1008.5 | 348 | 1006 | 519 |
| 225                  | RP               | 400 | 922 | 1042 | 55 | <sup>+0.030</sup> <sub>+0.011</sub> | 110 | 100 | M20 X 42 | 59.3 | 16 | 1008.5 | 348 | 1006 | 519 |
| 225                  | SP               | 400 | 922 | 1042 | 55 | <sup>+0.030</sup> <sub>+0.011</sub> | 110 | 100 | M20 X 42 | 59.3 | 16 | 1008.5 | 348 | 1006 | 519 |
| 225                  | MP               | 800 | 922 | 1042 | 55 | <sup>+0.030</sup> <sub>+0.011</sub> | 110 | 100 | M20 X 42 | 59.3 | 16 | 1008.5 | 348 | 1006 | 519 |
| 225                  | WP               | 800 | 922 | 1072 | 60 | <sup>+0.030</sup> <sub>+0.011</sub> | 140 | 125 | M20 X 42 | 64.4 | 18 | 1008.5 | 348 | 1006 | 519 |

# Integral Brakemotor Option Dimensions



Dimensions

Option IG - Incremental Encoder

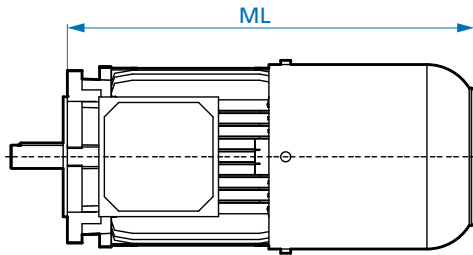

Option F - Forced Cooling Fan

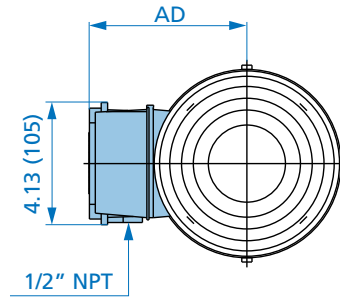
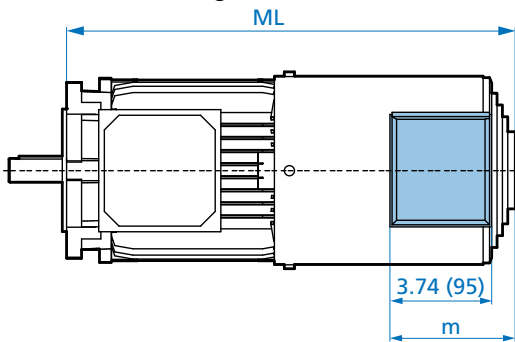

Option IG-F - Incremental Encoder & Forced Cooling Fan

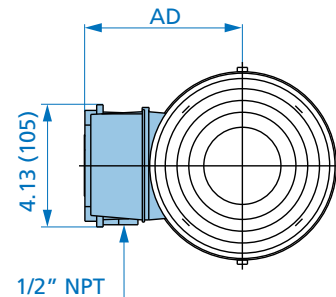
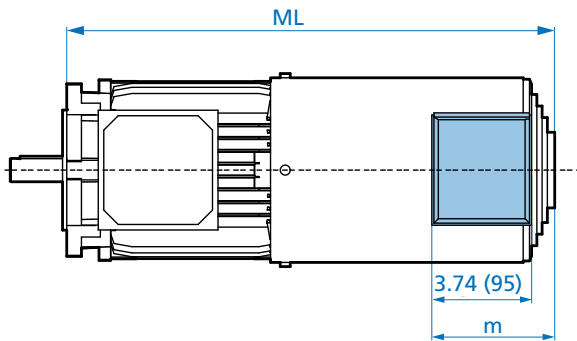

| inch<br>Motor<br>Frame | Efficiency<br>PE | BRE | IG<br>ML | ML    | F<br>m | AD   | ML    | IG F<br>m | AD   |
|------------------------|------------------|-----|----------|-------|--------|------|-------|-----------|------|
| 225                    | RP               | 400 | 38.94    | 43.80 | 5.67   | 9.82 | 47.34 | 5.67      | 9.82 |
| 225                    | RP               | 400 | 38.94    | 43.80 | 5.67   | 9.82 | 47.34 | 5.67      | 9.82 |
| 225                    | SP               | 400 | 38.94    | 43.80 | 5.67   | 9.82 | 47.34 | 5.67      | 9.82 |
| 225                    | MP               | 800 | 38.94    | 43.80 | 5.67   | 9.82 | 47.34 | 5.67      | 9.82 |
| 250                    | WP               | 800 | 38.94    | 43.80 | 5.67   | 9.82 | 47.34 | 5.67      | 9.82 |

| mm<br>Motor<br>Frame | Efficiency<br>PE | BRE | IG<br>ML | ML     | F<br>m | AD    | ML     | IG F<br>m | AD    |
|----------------------|------------------|-----|----------|--------|--------|-------|--------|-----------|-------|
| 225                  | RP               | 400 | 989      | 1112.5 | 144    | 249.5 | 1202.5 | 144       | 249.5 |
| 225                  | RP               | 400 | 989      | 1112.5 | 144    | 249.5 | 1202.5 | 144       | 249.5 |
| 225                  | SP               | 400 | 989      | 1112.5 | 144    | 249.5 | 1202.5 | 144       | 249.5 |
| 225                  | MP               | 800 | 989      | 1112.5 | 144    | 249.5 | 1202.5 | 144       | 249.5 |
| 250                  | WP               | 800 | 989      | 1112.5 | 144    | 249.5 | 1202.5 | 144       | 249.5 |

## UNICASE™ SPEED REDUCERS



### HELICAL IN-LINE

- Foot or Flange Mount
- Torque up to 205,000 lb-in
- Gear ratios – 1.82:1 to over 300,000:1



### NORDBLOC®.1 HELICAL IN-LINE

- Foot or Flange Mount
- Torque up to 26,550 lb-in
- Gear ratios – 1.88:1 to over 370:1



### PARALLEL HELICAL CLINCHER™

- Shaft, Flange or Foot Mount
- Torque up to 797,000 lb-in
- Gear ratios – 4.26:1 to over 300,000:1

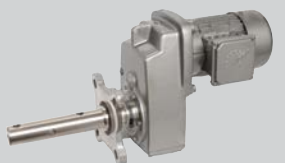

### SCP SCREW CONVEYOR PACKAGE

- Shaft, or Flange Mount
- Torque up to 53,100 lb-in
- Gear ratios – 4.32:1 to over 1500:1



### RIGHT ANGLE HELICAL-BEVEL 2-STAGE

- Foot, Flange or Shaft Mount
- Torque up to 5,840 lb-in
- Gear ratios – 4.1:1 to 70:1



### RIGHT ANGLE HELICAL-BEVEL

- Foot, Flange or Shaft Mount
- Torque up to 283,000 lb-in
- Gear ratios – 8.04:1 to over 300,000:1



### RIGHT ANGLE HELICAL-WORM

- Foot, Flange or Shaft Mount
- Torque up to 27,585 lb-in
- Gear ratios – 4.40:1 to over 300,000:1

## HIGH PERFORMANCE MOTORS & BRAKEMOTORS



### INVERTER/VECTOR DUTY

- Standard or Energy Efficient
- Integral, NEMA or Metric IEC
- 1/6 to 250 hp

## UNICASE™ SPEED REDUCERS



### MINICASE™ RIGHT ANGLE WORM

- Foot, Flange or Shaft Mount
- Torque up to 3,540 lb-in
- Gear ratios – 5:1 to 500:1



### FLEXBLOC™ WORM

- Modular bolt-on options
- Torque up to 4,683 lb-in
- Gear ratios – 5:1 to 3,000:1

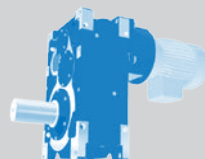

### MAXXDRIVE™ LARGE INDUSTRIAL GEAR UNITS PARALLEL HELICAL

- Modular bolt-on options
- Torque up to 2,027,000 lb-in
- Gear ratios – 5:1 to 1,600:1

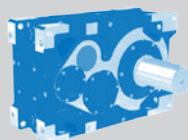

### MAXXDRIVE™ LARGE INDUSTRIAL GEAR UNITS HELICAL-BEVEL

- Modular bolt-on options
- Torque up to 2,027,000 lb-in
- Gear ratios – 5:1 to 1,600:1

## NORDAC AC VECTOR DRIVES



### SK180E FAMILY

- Distributed, simple speed control
- 380-480V, 3-phase to 3.0 hp
- 200-240V, 3-phase to 1.5 hp
- 200-240V, 1-phase to 1.5 hp
- 100-120V, 1-phase to 0.75 hp

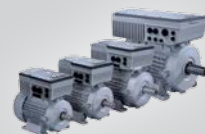

### SK200E FAMILY

- Distributed, high performance
- 380-480V, 3-phase to 30 hp
- 200-240V, 3-phase to 15 hp
- 200-240V, 1-phase to 1.5 hp
- 100-120V, 1-phase to 1 hp



### SK500E FAMILY

- Compact, cabinet mount, high performance
- 380-480V, 3-phase, to 125 hp
- 200-240V, 3-phase, to 25 hp
- 200-240V, 1-phase, to 3 hp
- 100-120V, 1-phase, to 1.5 hp



## Global Vision, Local Support

NORD makes its wide product range easily available through a global network that includes representation in over 60 countries. By providing all of our customers with prompt delivery, and expert support services, we are firmly committed to exceeding customer expectations and being responsive to the ideas and specifications of every customer, anywhere in the world.





#### **Global Presence**

Allows for short lead times and quick response times throughout the world.

#### **Modular Design**

More than 20 million totally unique product combinations guarantees that you won't need to look anywhere else.

#### **Quality Manufacturing**

NORD produces maintenance free products that have a long life in order to save you money for the long haul.

#### **Dependable Service**

With emergency service available 24/7 we can help you out when you need us most.

#### **Innovative Products**

Our engineers are hard at work creating solutions to everyday problems.

#### **We Have you Covered**

NORD provides Gear Drives, Motors & AC inverters in order to provide you with a complete Drivesystem solution.



## **NORD Gear Corporation**

MEMBER OF THE NORD DRIVESYSTEMS GROUP  
info.us@nord.com

**Waunakee, WI**  
800 NORD Drive  
Waunakee, WI 53597  
Tel. 608.849.7300

**Corona, CA**  
1180 Railroad St.  
Corona, CA 92882  
Tel. 951.393.6565

**Charlotte, NC**  
300 Forsyth Hall Dr.  
Charlotte, NC 53597  
Tel. 980.215.7575

## **NORD Gear Limited - Canada**

MEMBER OF THE NORD DRIVESYSTEMS GROUP  
info.ca@nord.com

**Brampton, ON**  
41 West Drive  
Brampton, ON L6T4A1  
Tel. 800.668.4378